

PARTS LIST

INTERNAL CHEMICAL HYDRAULIC VALVE

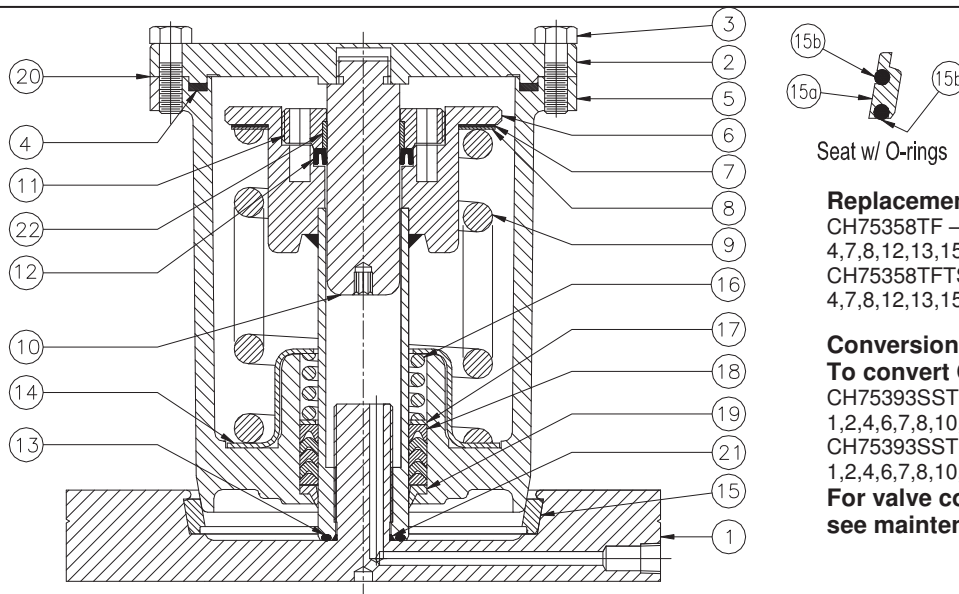

Replacement Kit of Teflon Parts

CH75358TF – Includes items
4,7,8,12,13,15,16,17,18,19,20,21
CH75358TFTS – Includes items
4,7,8,12,13,15a,15b,16,17,18,19,20,21

Conversion Kit

To convert CH45843SST to CH47003SST

CH75393SSTF – Includes items
1,2,4,6,7,8,10,11,12,13,15,16,17,18,19,20,21,22
CH75393SSTS – Includes items
1,2,4,6,7,8,10,11,12,13,15a,15b,16,17,18,19,20,21,22

**For valve conversion instructions,
see maintenance manual MM-CH005.**

No.	Description	Req.	Material	Part No.	No.	Description	Req.	Material	Part No.
1	Seat Flange	1	316 Stnls	46937SS	14	Packing Retainer	1	316 Stnls	19446SS
2	Cover Plate	1	316 Stnls	75160SS	15	Replaceable Seat	1	Teflon	16644TF
3	Cap Screw - Cover Plate	12	316 Stnls	9Q3305	15a	Replaceable Seat w/ O-rings		Kalrez	16644KA
4	Gasket - Cover Plate	1	Teflon	17295TF	15b	Seat O-ring only	2	Teflon	18897TFTS
5	Disc	1	316 Stnls Hast. C-22 Trim	27996LC001 28235LH001	15b	Seat O-ring only	2	Tef-Sil	18246TS
6	Stem/Spring Retainer	1	316 Stnls	75224SS	15b	Seat O-ring only	2	Kalrez	18246KA
7	Backup Shim-Spring	1	Teflon	16867TF	16	Spring-Stuffing Box	1	316 Stnls	19616SS
8	Shim-Spring	1	304 Stnls	16866SL	17	Follower Washer	1	316 Stnls	19594SS
9	Main Spring	1	316 Stnls	16890SS	18	Packing Rings	Set	Teflon	15759TF
10	Piston	1	303 Stnls	75161SL	19	Wiper - Suffing Box	1	Teflon	15862TF
11	Seal Retainer	1	316 Stnls	75162SS	20	Gasket - Cover Plate	1	Teflon	19720TF
12	Main Hydraulic Seal	1	PTFE/302SS	75207SSTF	21	O-ring - Stem Backup	1	Viton	3926VT
13	O-ring - Stem	1	Tef-Sil	75206TS	22	Bearing Ring	1	Teflon/Graphite	75455TF

INSTALLATION INSTRUCTIONS:

- Mount valve on mounting pad.
- Connect Hydraulic line to 1/8" NPT fitting on O.D. of seat flange leaving fitting loose.
- Operate pump until all air is bled from system.
- Tighten fitting and refill pump reservoir.
- Inspect all fittings for leaks.

WARNING:

Use only genuine BETTS INDUSTRIES, INC. replacement parts. Use of substitute parts can impair the proper function of this product and void all warranties.

REBUILDING VALVE: (Betts recommends using parts kit CH75358TF when rebuilding valve).

- Remove cap screws (3). Cover plate (2) can now be removed. Discard gaskets (4) and (20). Inspect piston (10), if piston (10) is scratched or damaged it should be replaced.
- Remove seal retainer (11) and stem/spring retainer (6) with spanner wrench 75325MS. Remove hydraulic seal (12).
 - Inspect Stem/spring retainer (6); if stem is damaged or scratched it must be replaced.
- Lift disc (5) off seat flange (1) and remove all components remaining in disc (5).
- Replace seat (15), wiper (19), packing (18), spring-stuffing box (16), stem O-ring seal (13) and backup seal (21) with new parts included in kit.
- Reinstall packing retainer (14), main spring (9) and shims (6) and (7).
- Thoroughly coat threads of seat flange (1) with a high quality removable thread lock compound and insert stem/spring retainer (6) through packing (18) and thread onto hub of seat flange (1); tighten to 90 ft lbs.
- Insert new hydraulic seal (12) with lips facing inwards apply anti-seize compound and install seal retainer (11); tighten to 30 ft lbs.
- Install new gaskets (4) and (20) and bolt cover plate assembly (2) using cap screws (3); tighten cap screws to 40 ft lbs.

For more detailed instructions, see maintenance manual MM-CH005