

### Clamp Ring Style

- EASILY INSTALLED
- LOW MAINTENANCE
- ECONOMICAL

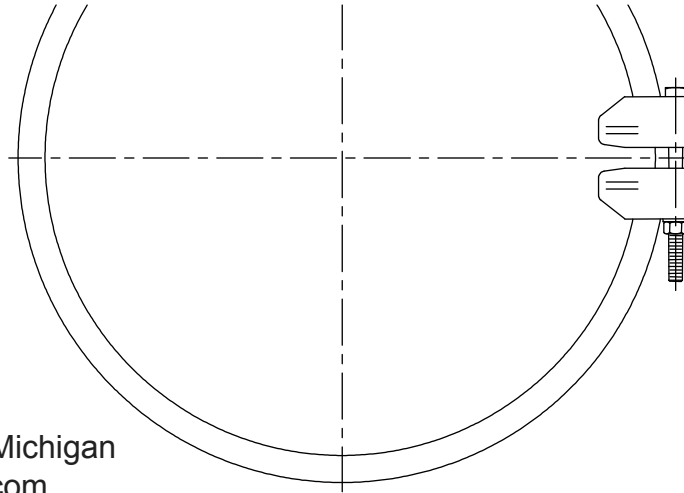

Tank Truck Service & Sales, Inc. Warren, Michigan  
800-482-2678 www.tanktruckservice.com

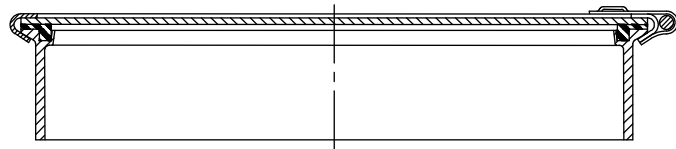

MODEL 8007

Tiona Inspection Manholes provide quick, safe entrance and exit from your tanks. Heavy gauge metal and welded construction minimizes maintenance. Manholes are certified and marked in accordance with 49CFR178.345-5 with a test pressure of 36 psi [2.48 bar].

Cover Plate	Clamping Ring	Clamping Bolt and Washer	Clamping Bolt Nut	Weight	Assembly No.
Steel Zinc Plt.	Steel Zinc Plt.	Steel Zinc Plt.	Brass	15.8 lb. [7.2 kg]	8007BX*
Stnls 304	Stnls 304	Stnls 304	Stnls 304	16.4 lb. [7.4 kg]	8007CX*
Stnls 316	Stnls 304	Stnls 304	Stnls 304	16.4 lb. [7.4 kg]	8007DX*

\* Add letters to part number to designate seal material. See material table at right for designation.

"X" in assembly number designates manhole collar sold separately. Collars are available in aluminum, steel and stainless steel. Please see parts page for part numbers.

Letter	Gasket Material	Temp. Range
B	Buna-N	-40°F to +220°F [-40°C to +104°C]
V	Viton®	-20°F to +400°F [-29°C to +204°C]
P	EPDM (White)	-40°F to +260°F [-40°C to +127°C]
W	White Hypalon	-40°F to +250°F [-40°C to +121°C]
T	PTFE Envelope w/ White Hypalon Insert	-40°F to +250°F [-40°C to +121°C]

During installation and welding to the tank, care should be exercised to insure collars remain flat and round. If necessary, a welding fixture should be used to prevent distortion.

# Parts List

## 16" Inspection Manhole

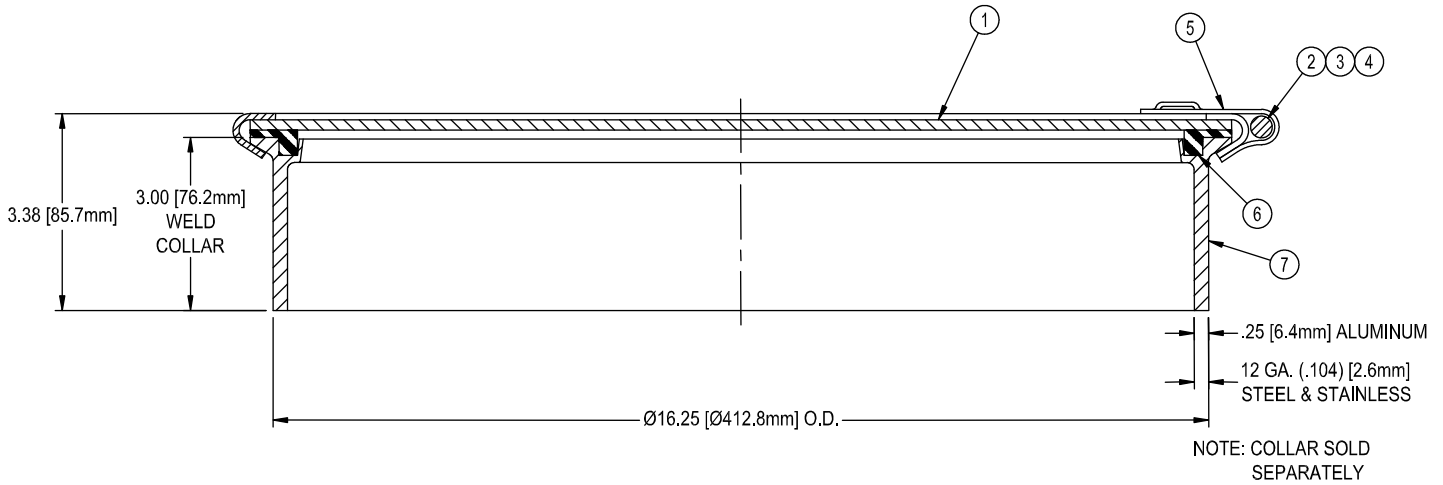

NO.	REQ.	DESCRIPTION	MATERIAL	PART NO.	
1	1	Cover Plate	B	Steel Zinc Plated	3026ZC
			C	304 Stainless Steel	3026SL
			D	316 Stainless Steel	3026SS
2	1	Bolt – Clamp Ring ( <sup>3</sup> / <sub>8</sub> – 16 Thd.) *	Steel Zinc Plated	3029ZC	
			304 Stainless Steel	3029SL	
3	1	Nut – Clamp Ring ( <sup>3</sup> / <sub>8</sub> – 16 Thd.) *	Brass	3030BR	
			304 Stainless Steel	9Q5809	
4	1	Washer – Clamp Ring *	Steel Zinc Plated	3031ZC	
			304 Stainless Steel	3031SL	
5	1	Clamp Ring	Steel Zinc Plated	3028ZC	
			304 Stainless Steel	3028SL	
6	1	Manhole Gasket (Channel Style)	B	Nitrile (Buna-N)	3559BN
			V	FKM (Viton®)	3559VT
			P	EPDM (White)	3559WE
			W	White Hypalon	3559WH
		Manhole Gasket (Flat Style)	T	PTFE Envelope w/ W. Hypalon Insert	3025TF
7	1	Manhole Collar (Sold Separately)	Steel	3057MS	
			1/4" Aluminum	3057AE	
			304 Stainless Steel	3057SL	
			316 Stainless Steel	3057SS	

\* Use part # 4121ZC001 for kit with Nut (3), Bolt (2), and Washer (4).

**MAINTENANCE:** Manhole assemblies should be inspected with sufficient frequency and due regard to the products carried to insure a liquid tight closure. Any worn, damaged or missing parts must be replaced. Gaskets should be replaced if their effectiveness is impaired in any way. Replacement gaskets must be compatible with products carried.

**WARNING:** Use only genuine BETTS INDUSTRIES INC. replacement parts. Substitute parts can impair the proper function of this product.