

- Dual Purpose Vent
- Roll Over Protection
- Compact Design
- Interior Mount

A normal vent designed for use on MC306 & DOT406 cargo tanks. Model 6496 has a pressure setting per 178.346-3(b)(2) of "not less than 1 PSIG" and a vacuum setting per 178.346-3(c)(2) "no more than 6 ounces" which allows for efficient recovery of vapors during closed system loading and off-loading. Unique roll over protection retains product at any attitude of rollover. Vent is flow tested and marked.

**NOTE:** While normal vents provide limited vapor venting during loading/unloading, it is recommended that positive vapor valves (typically air operated) be provided when loading/unloading with the manhole closed. If positive vapor valves are not used, insure normal vent is functioning properly or open manhole cover before beginning loading/unloading. Failure to do so may result in head reversals or other tank failure.

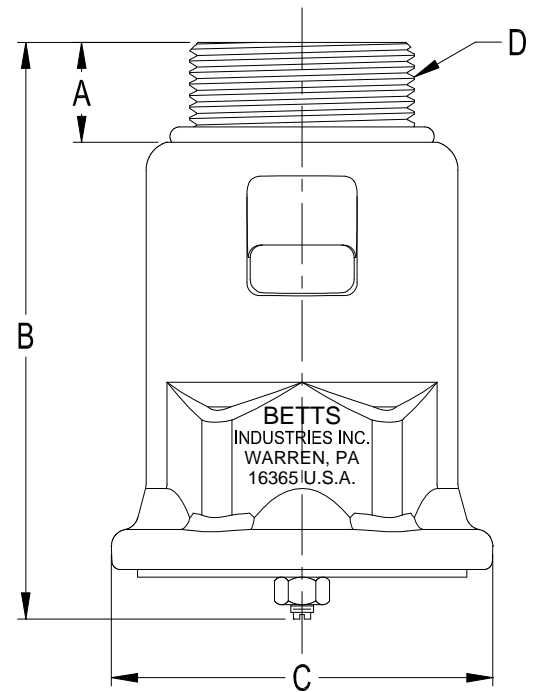

See Section 95 Page 1D for parts list and maintenance instructions.

Description	Assembly No.	Body Mat'l	Set Pressure**		Flow Capacity		Dimensions				Wt. (lbs).				
			Pressure (psig)	Vacuum (psig)	Out-breathing	In-breathing	A	B	C	D (Threads)					
FVA MC306 Normal Vent	6238AL*	Alum.	0.8 to 1.0	0.25 to 0.375	1,750 CF @ 3 psi	3,350 CFH @ 1 psi	.72"	4.16"	2.75"	1 <sup>5</sup> / <sub>8</sub> -12UN	1.0 lb.				
	6238SL*	303 SS									2.5 lb.				
PPV DOT406 Normal Vent	6496AL*	Alum.	1.0 to 1.5	0.25 to 0.375	1,200 CFH @ 3 psi	3,350 CFH @ 1 psi					.72"	4.16"	2.75"	1 <sup>5</sup> / <sub>8</sub> -12UN	1.0 lb.
	6496SL*	303 SS													2.5 lb.

Letter	Mat'l	Temp. Range
B	Buna-N	-40°F to +220°F
V	Viton®	-20°F to +400°F
EP	EPDM (Black)	-40°F to +260°F

\* Add letters to part number to designate seal material. See material table at right for designation.

\*\* Proper maintenance is required to ensure effective performance of normal vent. Dust, dirt, or residue will reduce the ability of the vent to hold required set-pressure.

Tank Truck Service & Sales, Inc. Warren, Michigan  
800-482-2678 [www.tanktruckservice.com](http://www.tanktruckservice.com)

# Parts List

## Pressure/Vacuum Normal Vent

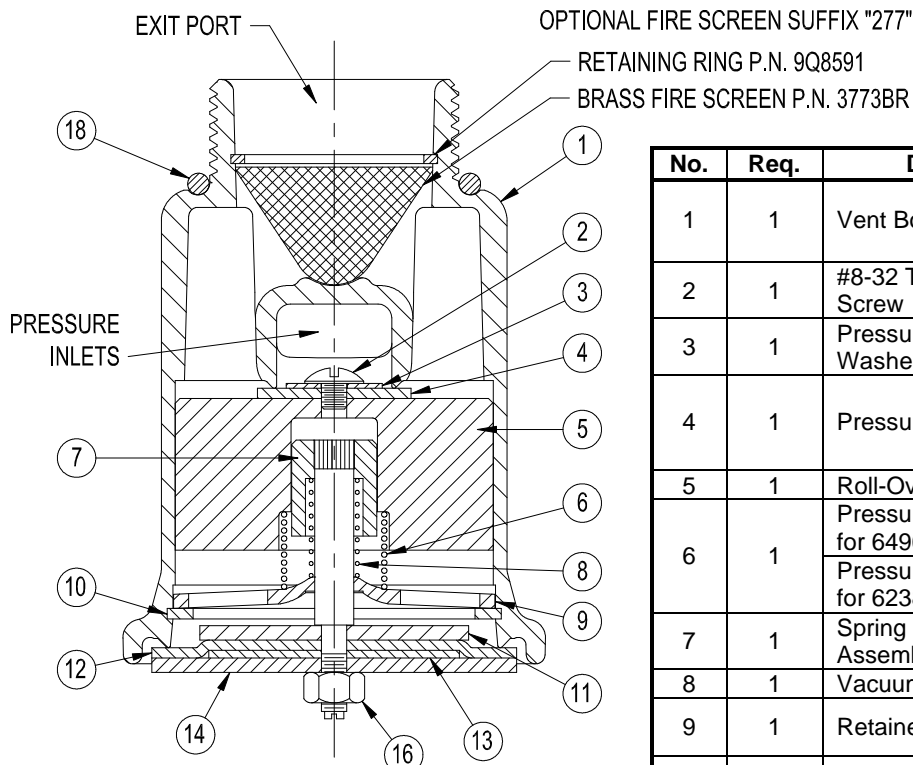

### Inspection & Maintenance

Per TTMA Technical Bulletin No. 92 "Inspect pressure relief valves and normal pressure/vacuum valves with sufficient frequency, but no less than once a month, to insure they are operational. Corroded parts must be replaced. Valves that are filled with residue must be cleaned. If venting devices are not operational, do not operate the cargo tank until the venting devices are repaired or replaced. Failure to follow this procedure can result in liquid or vapor leakage and tank damage."

To inspect vent, remove from tank and check for obstructions in the exit port and pressure inlets. Shake vent to ensure roll-over guide block (#5) slides freely up and down. The vacuum disc (#14) is spring-loaded and should open approximately  $\frac{1}{8}$ " to expose vacuum seat when the hex nut (#16) is gripped with a pair of pliers and pulled directly down.

Dirt and residue can be cleaned from the vent by soaking in mild detergent, rinsing with clean water, and blowing out with compressed air.

For more detailed instructions refer to the most recent version of Engineering Bulletin 1-99

No.	Req.	Description	Material	Part No.
1	1	Vent Body	Aluminum	7516AL001
			303 SS	7533SL
2	1	#8-32 Truss Hd. Mach. Screw	304 SS	9Q8216
3	1	Pressure Disc Retainer Washer	Nylon	3645NY
4	1	Pressure Seal Disc	Buna-N	3644BN
			Viton®	3644VT
			EPDM	3644EP
5	1	Roll-Over Guide Block	303 SS	3640SL
6	1	Pressure Relief Spring for 6496 (DOT406)	302 SS Coated Black	3812SL
		Pressure Relief Spring for 6238 (MC306)	302 SS Coated Blue	3725SL
7	1	Spring Collar Assembly	304 SS	3643SL
8	1	Vacuum Relief Spring	302 SS	3653SL
9	1	Retainer Plate	Aluminum	3649AL
			316 SS	3649SS
10	1	Retaining Ring	Steel Zc. Plt.	9Q8206
			Stainless	9Q8207
11	1	Vacuum Disc Retainer Washer	Aluminum	3647AL
			316 SS	3647SS
12	1	Vacuum Seal Disc	Buna-N	3646BN
			Viton®	3646BN
			EPDM	3646EP
13	1	Vacuum Spacer Washer	Nylon	3675NY
14	1	Vacuum Disc Support & Rating Plate For 6496 (DOT406)	Aluminum	3969AL
		Vacuum Disc Support & Rating Plate For 6238 (MC306)	316 SS	3969SS
16	1	Hex. Nut with Nylon insert #8-32 Thd.	Aluminum	3648AL
			316 SS	3648SS
18	1	Mounting O-Ring	Steel Zc. Plt.	9Q8220
			304 SS	9Q9348
			Buna-N	17211BN
			Viton®	17211VT
			EPDM	17211EP

3795RK\* - Repair kit for 6238AL\* } Kits include item #'s  
4141RK\* - Repair kit for 6496AL\* } 2,3,4,6,8,12,13,14,16,&18

\* Add letters to part number to designate seal material. See table in Section 95 Page 1C.

**WARNING:** Use only Betts Industries, Inc replacement components. Use of substitute parts can impair the proper function of this product and void all warranties.